

VUBD undercounter beverage dispenser – dimensions

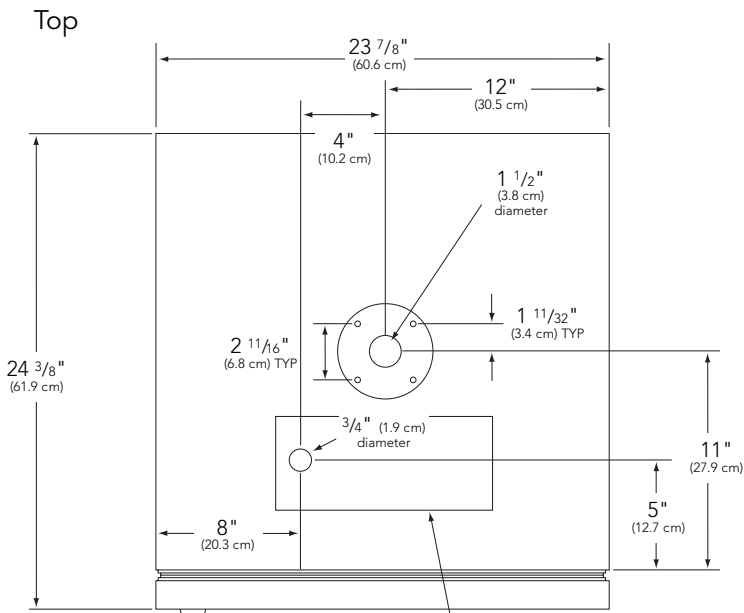

*Actual dimension of drain pan is 12" x 5" (30.5 cm x 12.7 cm)

Undercounter cutout

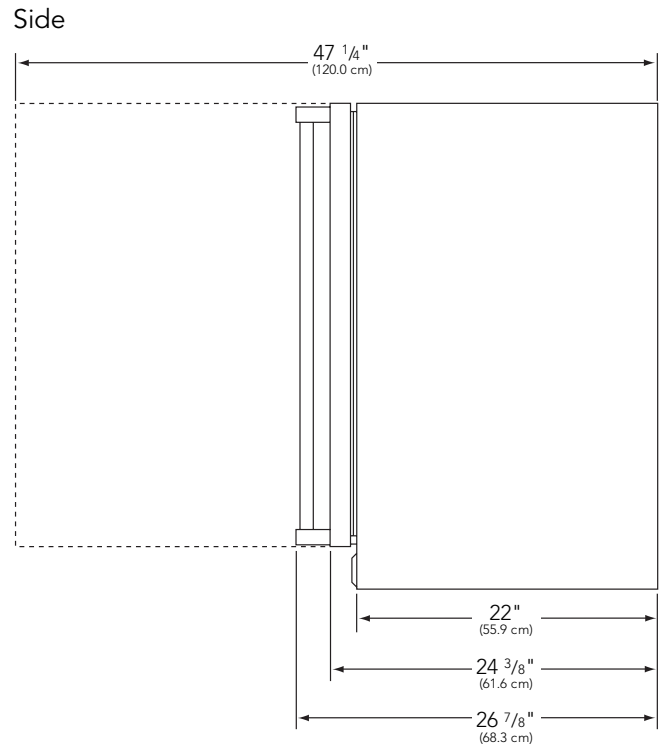
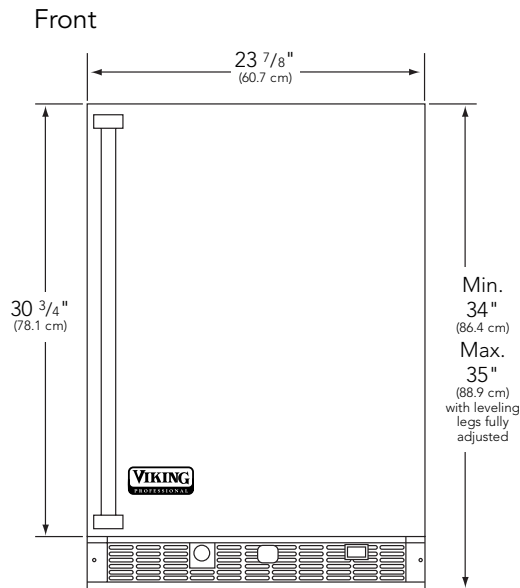
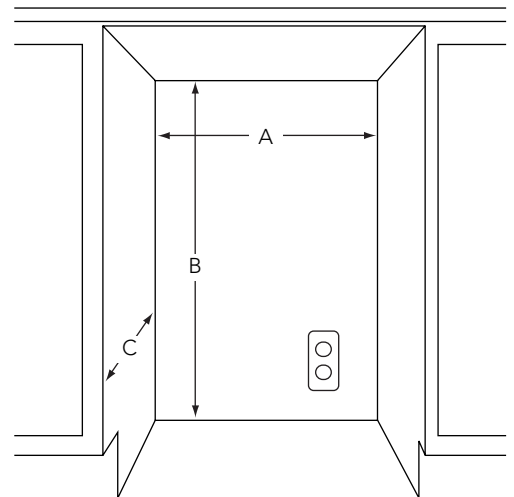

UNDERCOUNTER CUTOUT

A	24" (61.0 cm)*
B	Min. 34 1/8" (87.9 cm) Max. 35 1/8" (89.2 cm)
C	24" (61.0 cm)

*24" (61.0 cm) width for cabinet only. If door is recessed between cabinets, cabinet cutout must be 24 1/4" (61.6 cm).

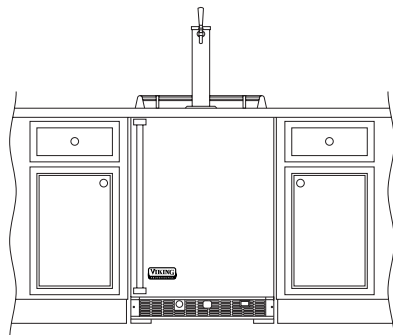

Cabinet cutout

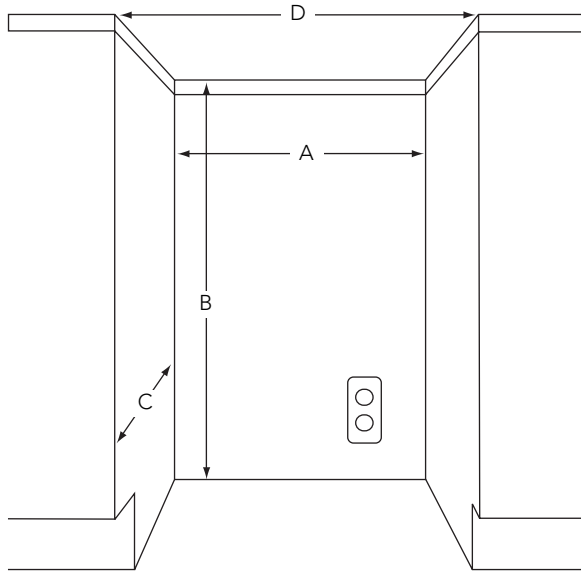

CABINET CUTOUT	
A	24" (61.0 cm)*
B	35 9/16" (90.3 cm)**
C	24" (61.0 cm)
D	24 3/4" (62.9 cm)

*24" (61.0 cm) width for cabinet only. If door is recessed between cabinets, cabinet cutout must be 24 1/4" (61.6 cm).

**35 9/16" (90.3 cm) height is without casters mounted to unit. 39 3/4" (101.0 cm) needed for height clearance with casters.

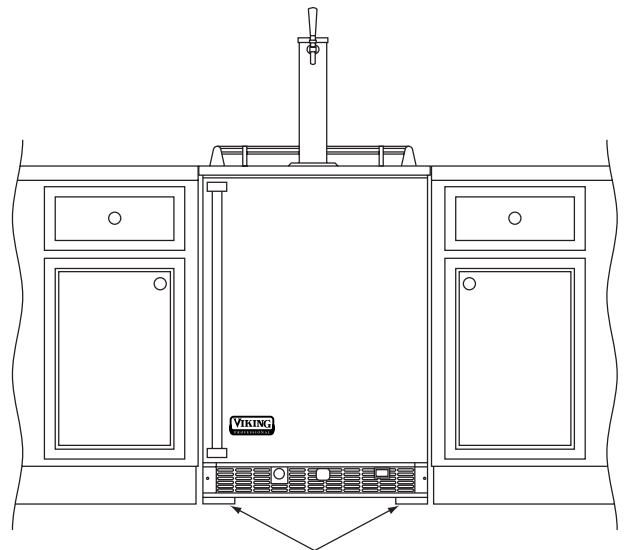
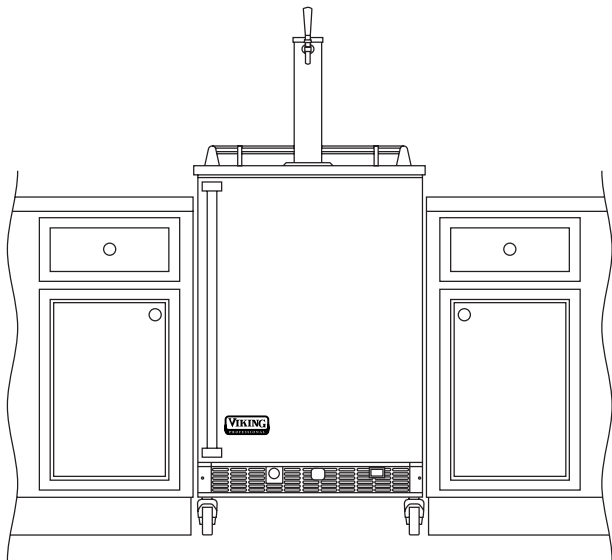

If removing the casters is necessary for installation, the unit should be raised off the ground. This should be done with an approved material. (Consult local building codes for approved material.)

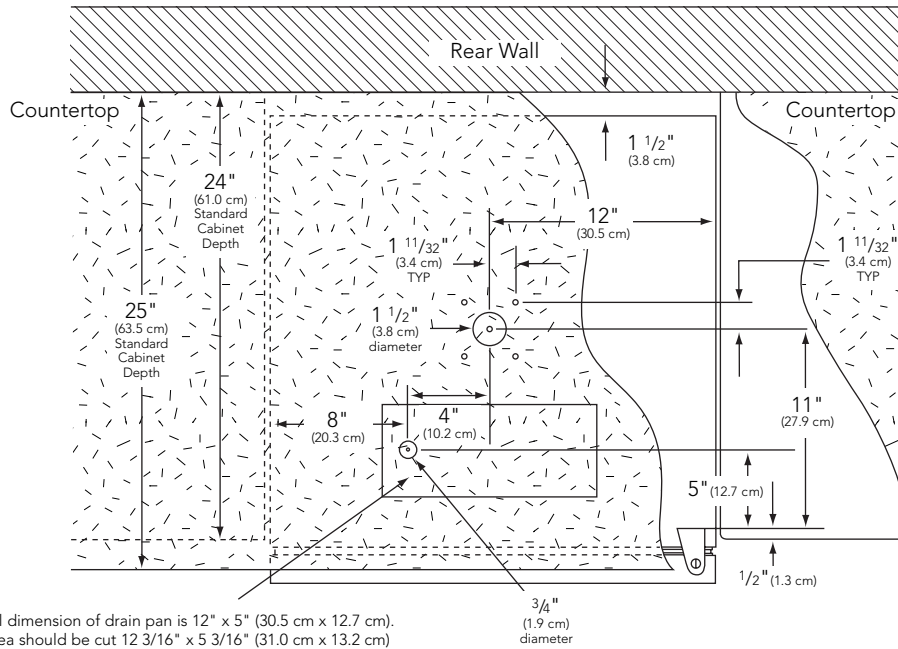

Basic specifications

Description	BEVERAGE DISPENSER
	VUBD140T
Overall Width	23 7/8" (60.7 cm)
Overall Height (to top of tower)	Minimum 47 3/4" (121.3 cm) Maximum 48 3/4" (123.8 cm)
Overall Depth from Rear (to end of handle brackets)	26 7/8" (68.3 cm)
Cutout Width (without casters)	24" (61.0 cm)*
Cutout Height (without casters)	Minimum 34 1/8" (87.9 cm) Maximum 35 1/8" (89.2 cm)
Cutout Depth	24" (61.0 cm)
Electrical Requirements	115VAC/60Hz
Maximum Amp Usage	3.3 amps
Maximum Storage Capacity	1/2 barrel – 15.5 gal. (58.7 L)
Approximate Shipping Weight	177 lb. (79.7 kg)

* 24" (61.0 cm) width for cabinet only. If door is recessed between cabinets, cabinet cutout must be 24 1/4" (61.6 cm).